



REAL  FLAME

IGNITE
XLF50
INSTALLATION KIT

ASSEMBLY & INSTALLATION MANUAL

XLF50IK - VERSION 1



REAL FLAME IGNITE XLF50 INSTALLATION KIT

TABLE OF CONTENTS

- 1. Fasteners Included 2
- 2. Tools Required 2
- 3. Enclosure Assembly 3
 - 3.1. Step 1 3
 - 3.2. Step 2 3
 - 3.3. Step 3 4
 - 3.4. Step 4 4
 - 3.5. Step 5 5
 - 3.6. Step 6 5
 - 3.7. Step 7 6
- 4. Enclosure Wall Mounting 7
 - 4.1. Step 1 7
 - 4.2. Step 2 8
 - 4.3. Step 3 9
 - 4.4. Step 4 10
 - 4.5. Step 5 11
 - 4.6. Step 6 12
 - 4.7. Step 7 13
- 5. Dimensions 14
- 6. Warranty 15
 - 6.1. Australia Warranty Claims . . . 16
 - 6.2. NZ Warranty Claims 16
- 7. Notes 17

1. FASTENERS INCLUDED

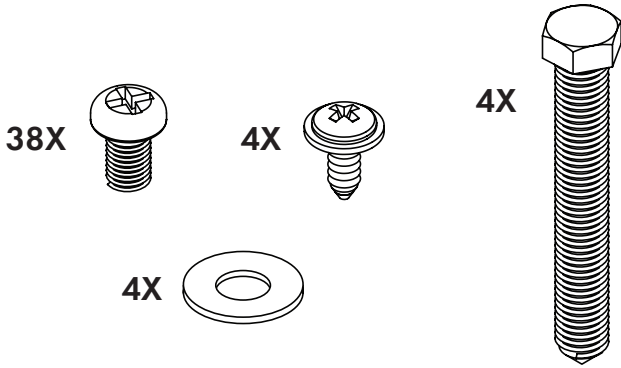

2. TOOLS REQUIRED

The Real Flame Ignite XLF50 Installation Kit can be installed using a power drill, phillips head bit, **3mm** wood drill bit and an **M6/10mm** socket bit. These tools are not supplied with the kit.

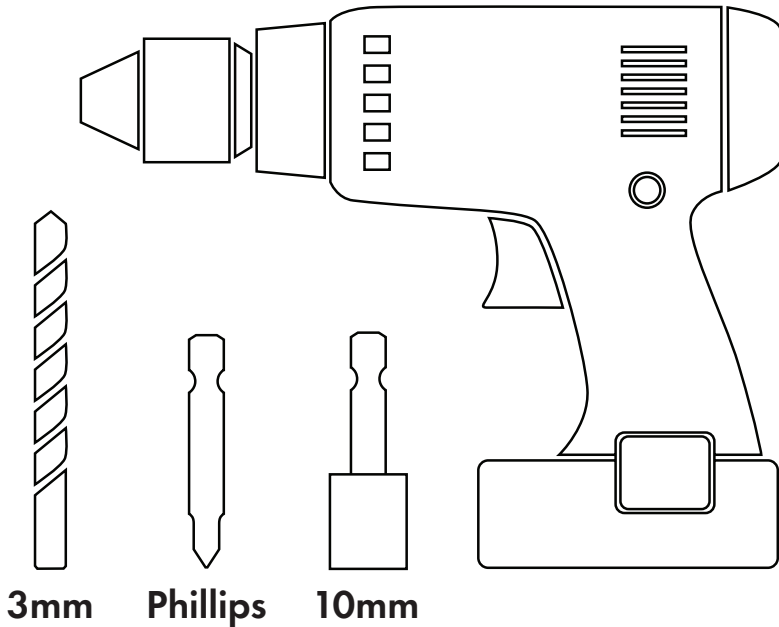

3. ENCLOSURE ASSEMBLY

3.1. STEP 1

After unboxing the XLF50 unit, remove the **4X** trim pieces attached to the top, bottom and sides of the unit with **12X** screws. Retain **4X** screws, as these will be used later.

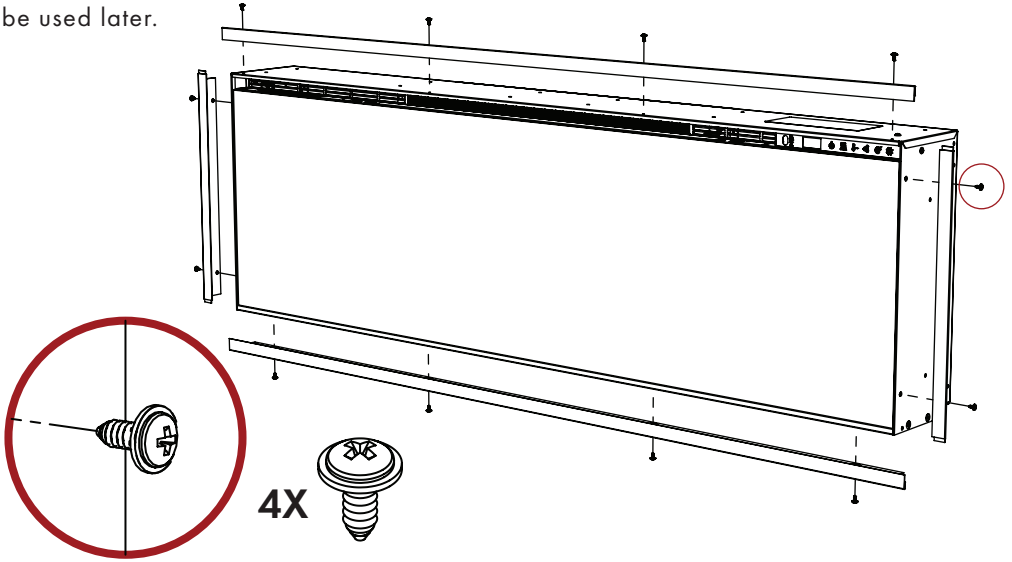

3.2. STEP 2

Once the trims have been removed, lay the unit face down on a soft surface such as a rug or carpet.

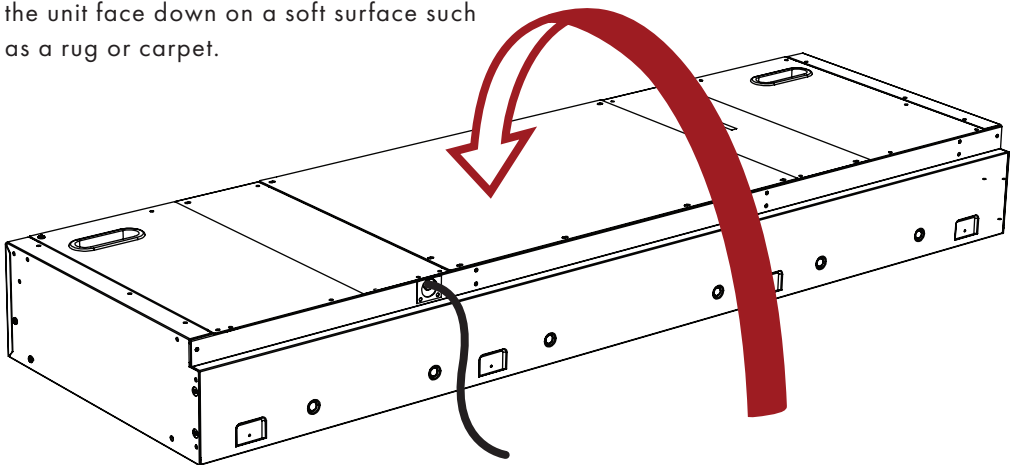

3.3. STEP 3

Install the Bottom Panel of the Enclosure using **4X** screws supplied with the XLF50 unit (removed from trims in Step 1), routing power cord through the cut out in the Bottom Panel.

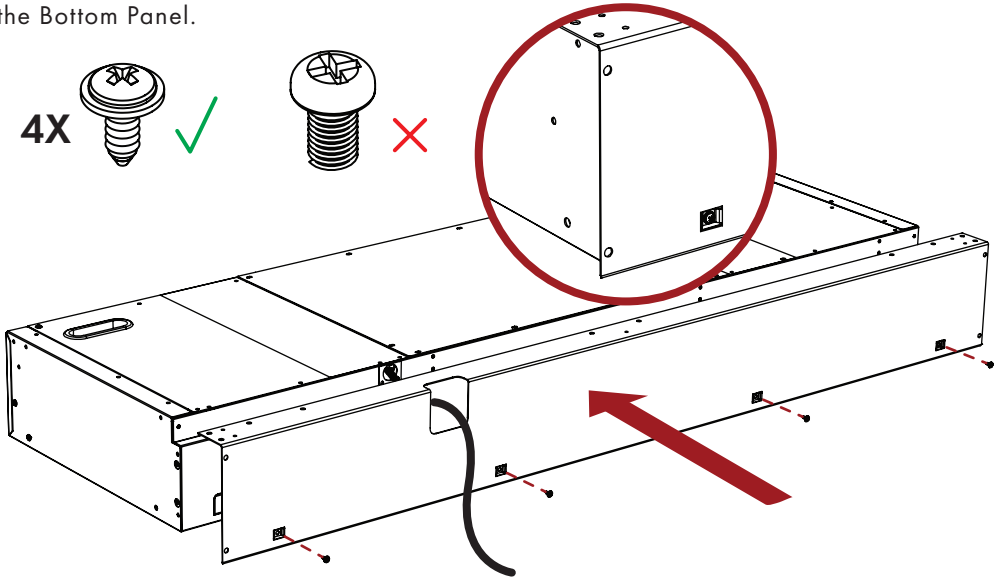

3.4. STEP 4

Attach **2X** Side Panels to Bottom Panel using **8X** screws.

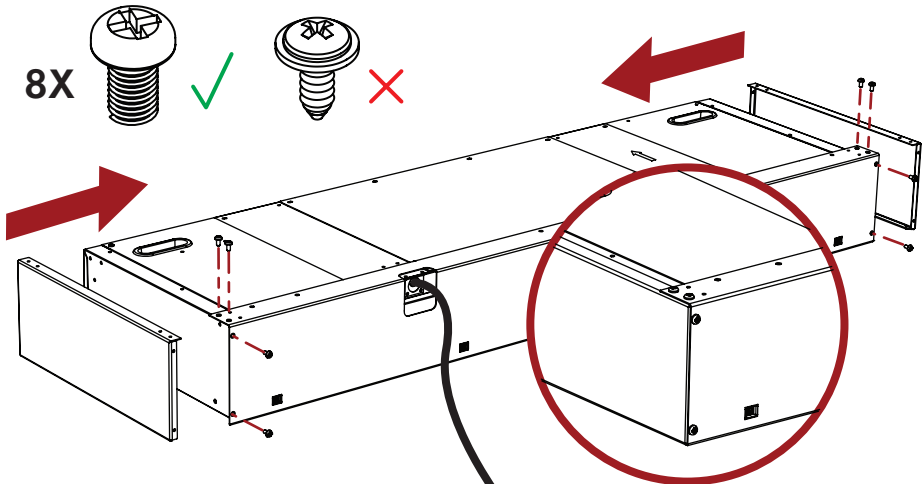

3.5. STEP 5

Attach Top Panel to Side Panels using **8X** screws.

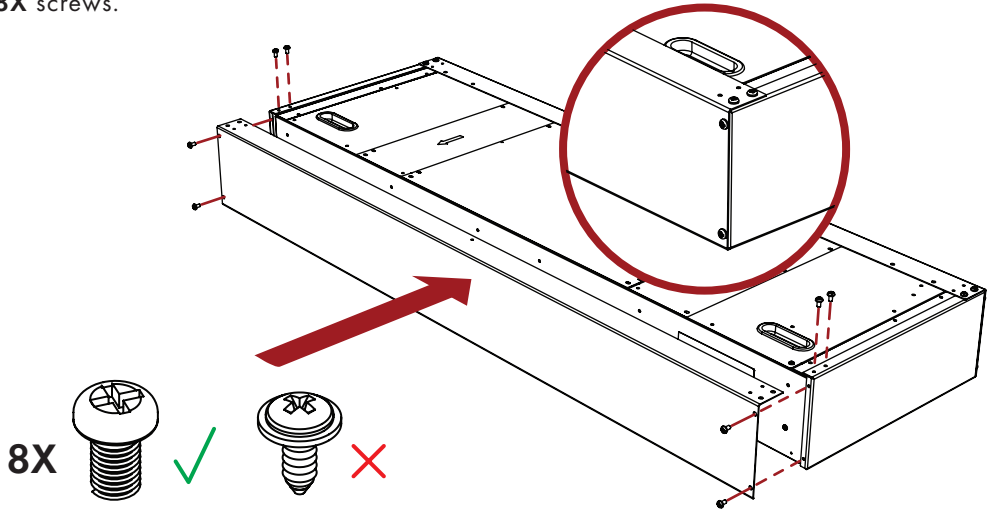

3.6. STEP 6

Attach Mounting Frame to Top and Bottom Panels using **10X** screws.

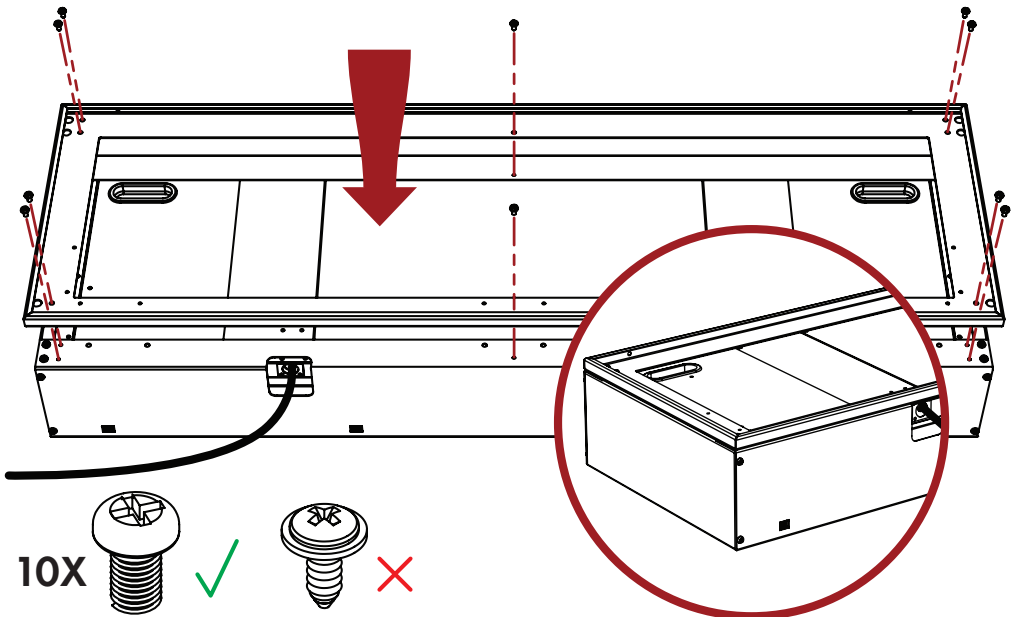

3.7. STEP 7

Attach **3X** Mounting Rails to Mounting Frame using **10X** screws.

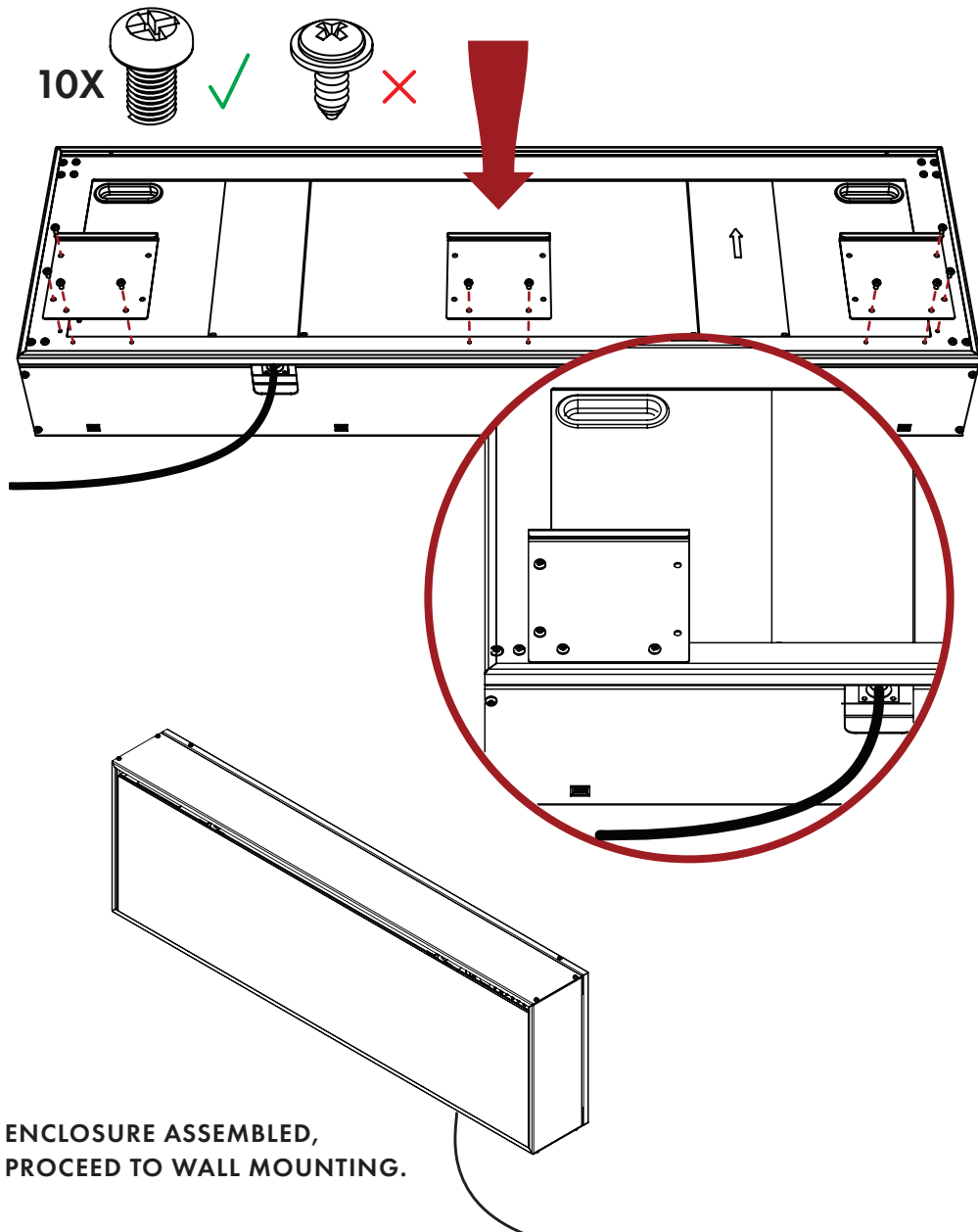

4. ENCLOSURE WALL MOUNTING

To aid in a successful installation, it is advised that two people help when wall mounting the Enclosure.

4.1. STEP 1

First, locate **2X** timber studs on the intended installation wall.

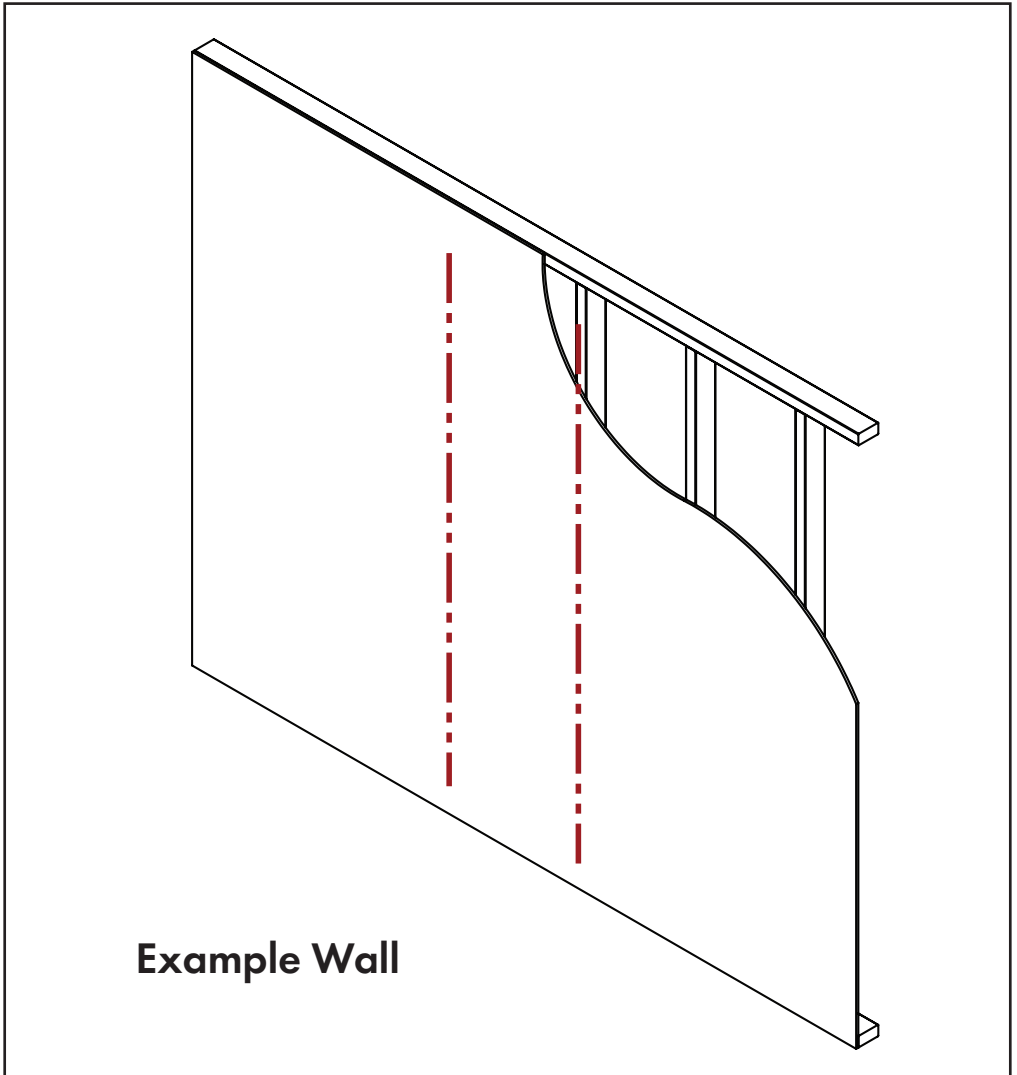

4.2. STEP 2

Using two people - lift Wall Mounting Hanger into place, aligning slots with the previously located studs, use slot adjustment to centralise the Hanger as necessary. For optimal viewing height, measure **730mm** from the bottom of the Wall Mounting Hanger to the ground. Use the spirit level provided with the XLF50 unit to ensure the Wall Mounting Hanger is level, before marking the wall in **4X** places to drill pilot holes.

NOTE

The Enclosure can be mounted at any height if desired, under the condition that room is left for the power cord to run below it.

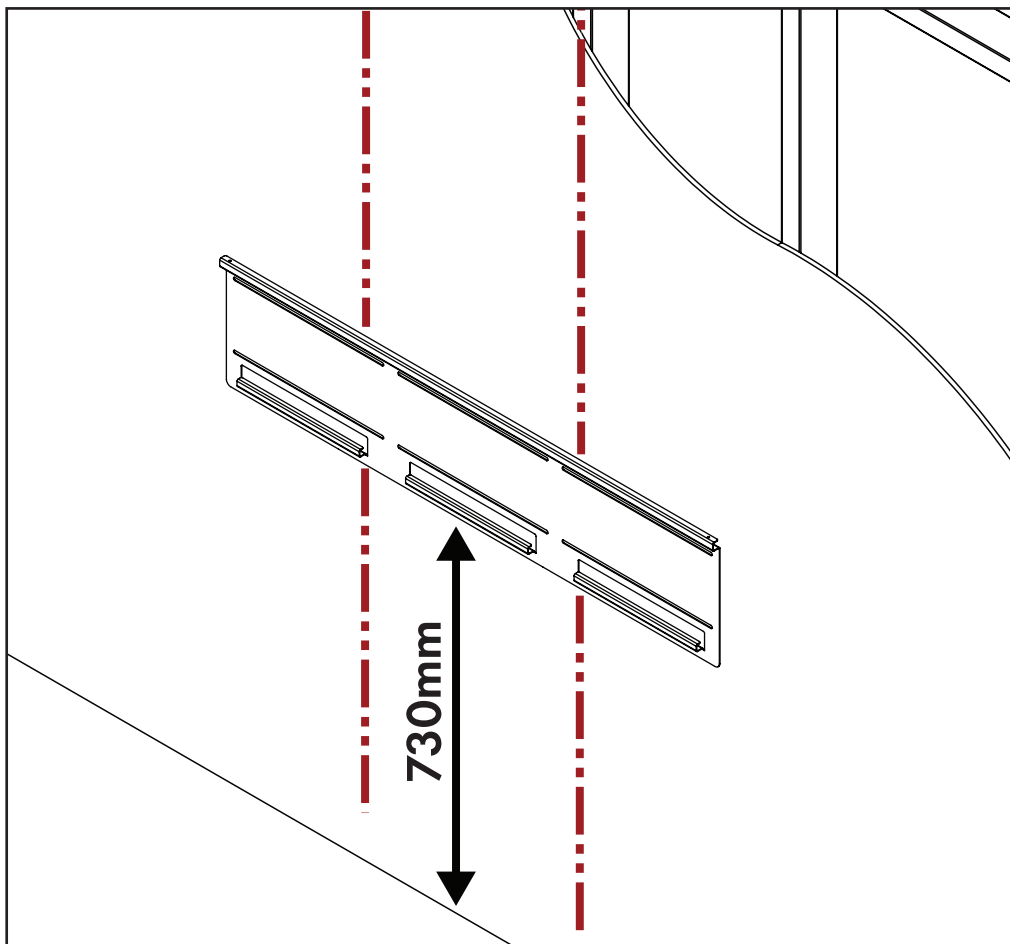

4.3. STEP 3

Using marks from the previous step, drill **4X** pilot holes to a depth of **50mm** using a **3mm** drill bit.

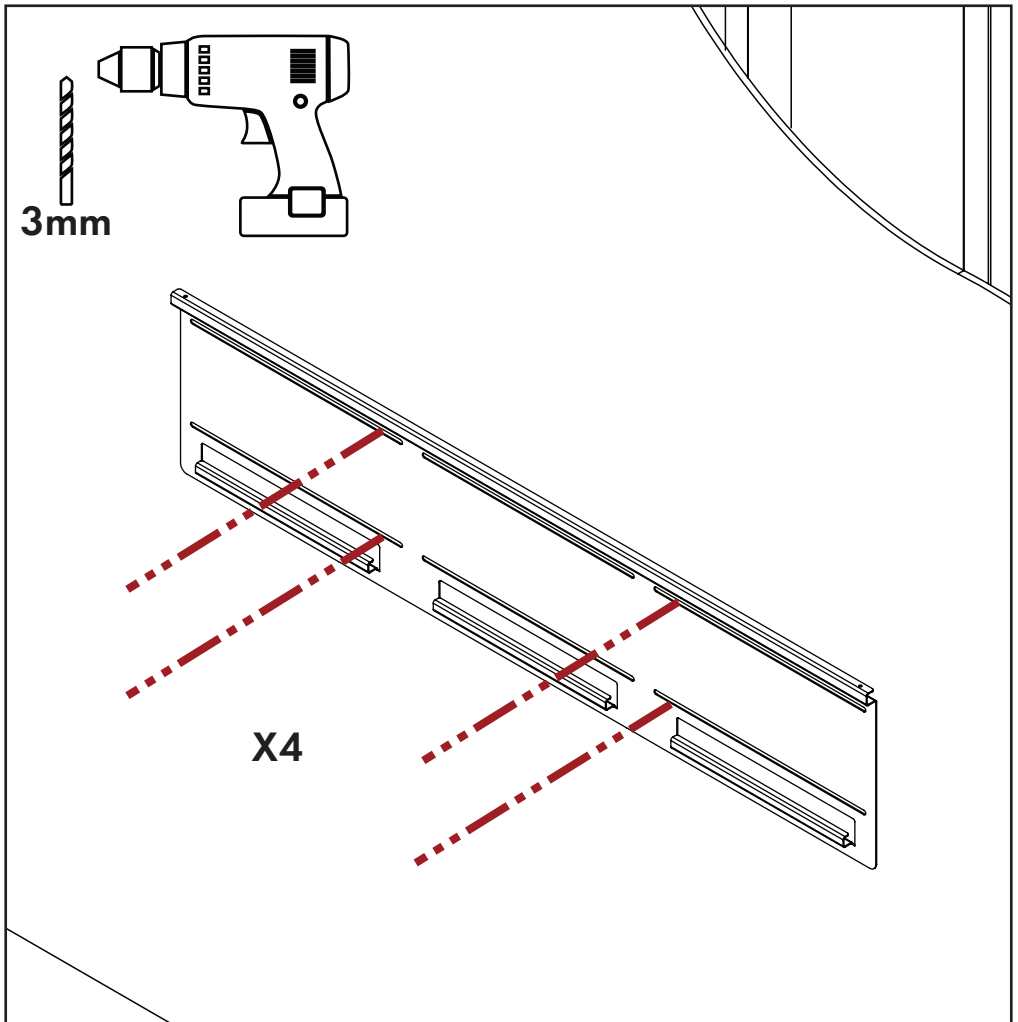

4.4. STEP 4

Using two people - lift Wall Mounting Hanger into position, aligning slots with previously drilled pilot holes. Drive **4X M6 X 50mm** screws with **4X** washers into studs using **M6/10mm** socket bit. Do not drive screws to full depth at first, to allow for small adjustments as necessary. Once desired positioning is achieved, drive screws to full depth.

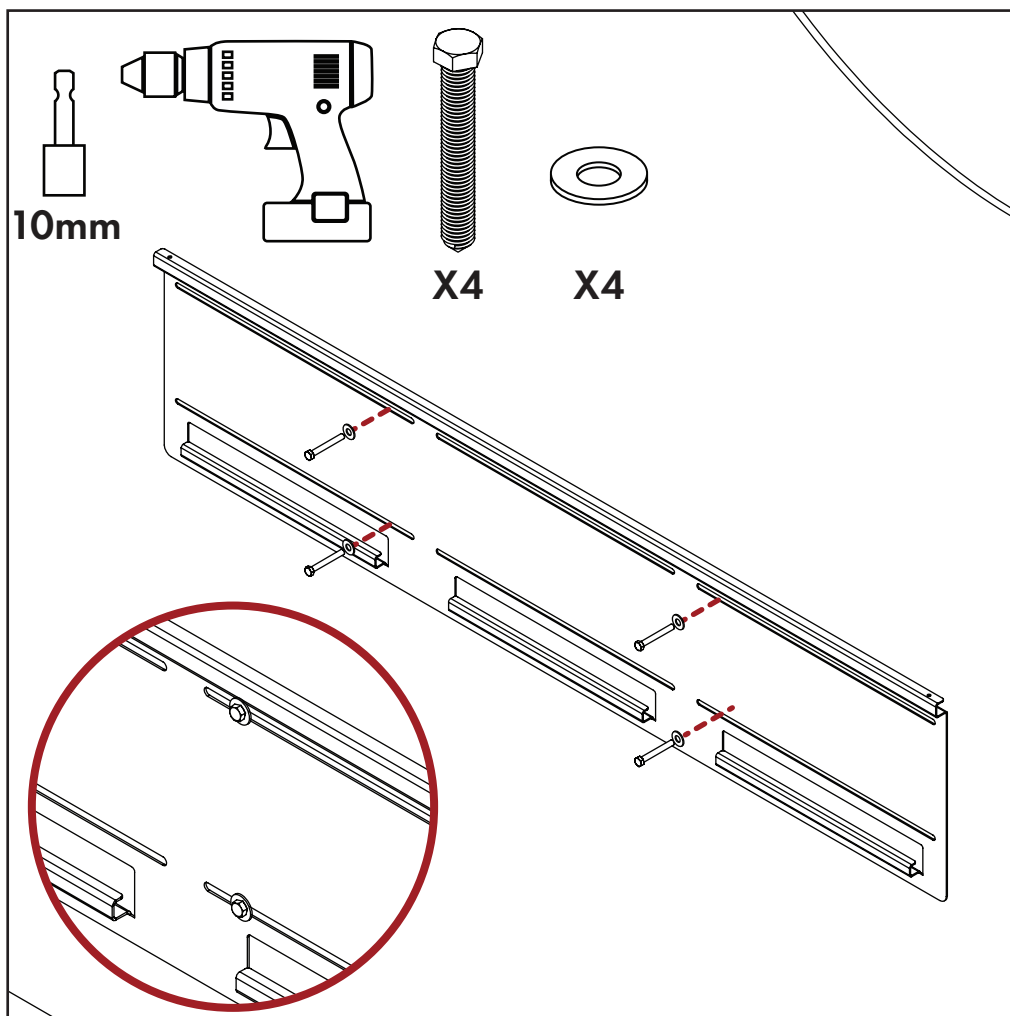

4.5. STEP 5

Using two people - lift assembled Enclosure into place on Wall Mounting Hanger. Locate the top hanger into the top of the Mounting Frame and the bottom hangers into the **3X** Mounting Rails.

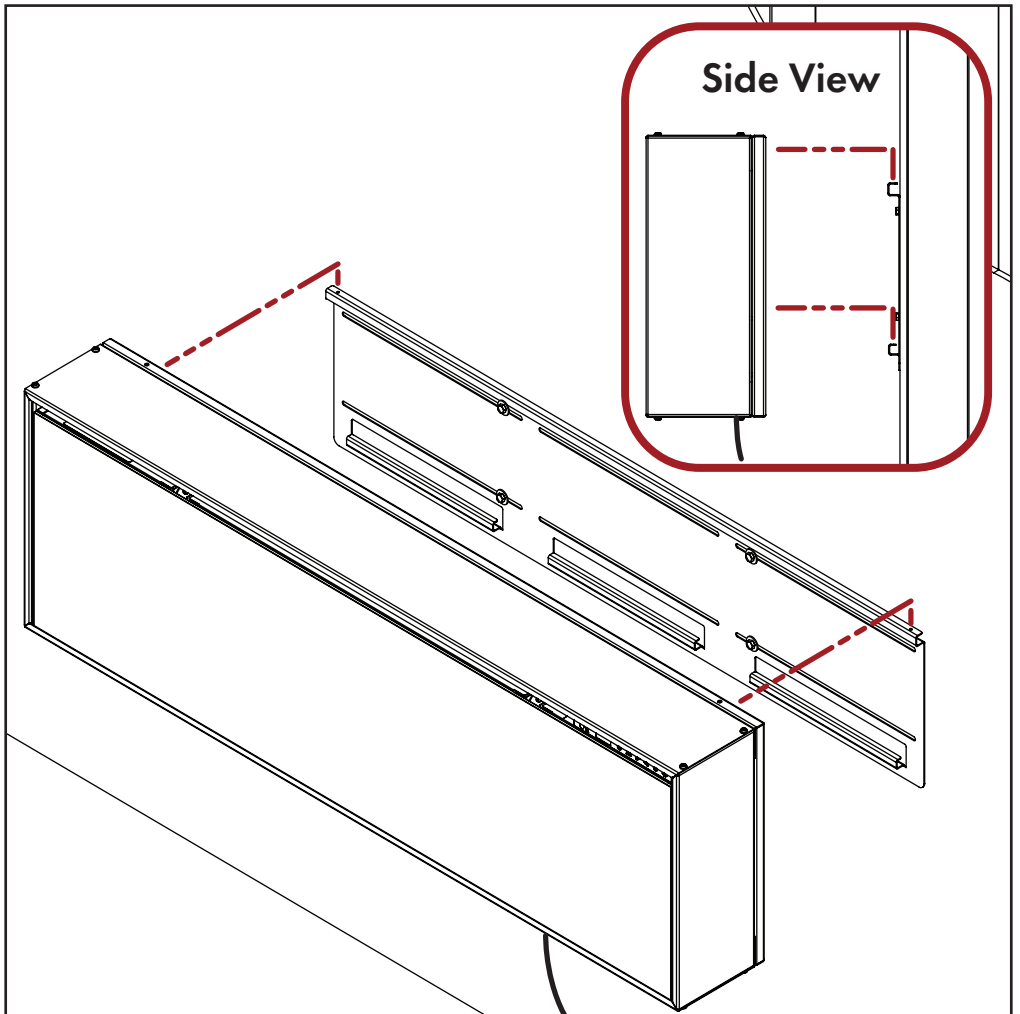

4.6. STEP 6

Secure the Enclosure to the Wall
Mounting Hanger with **2X** screws.

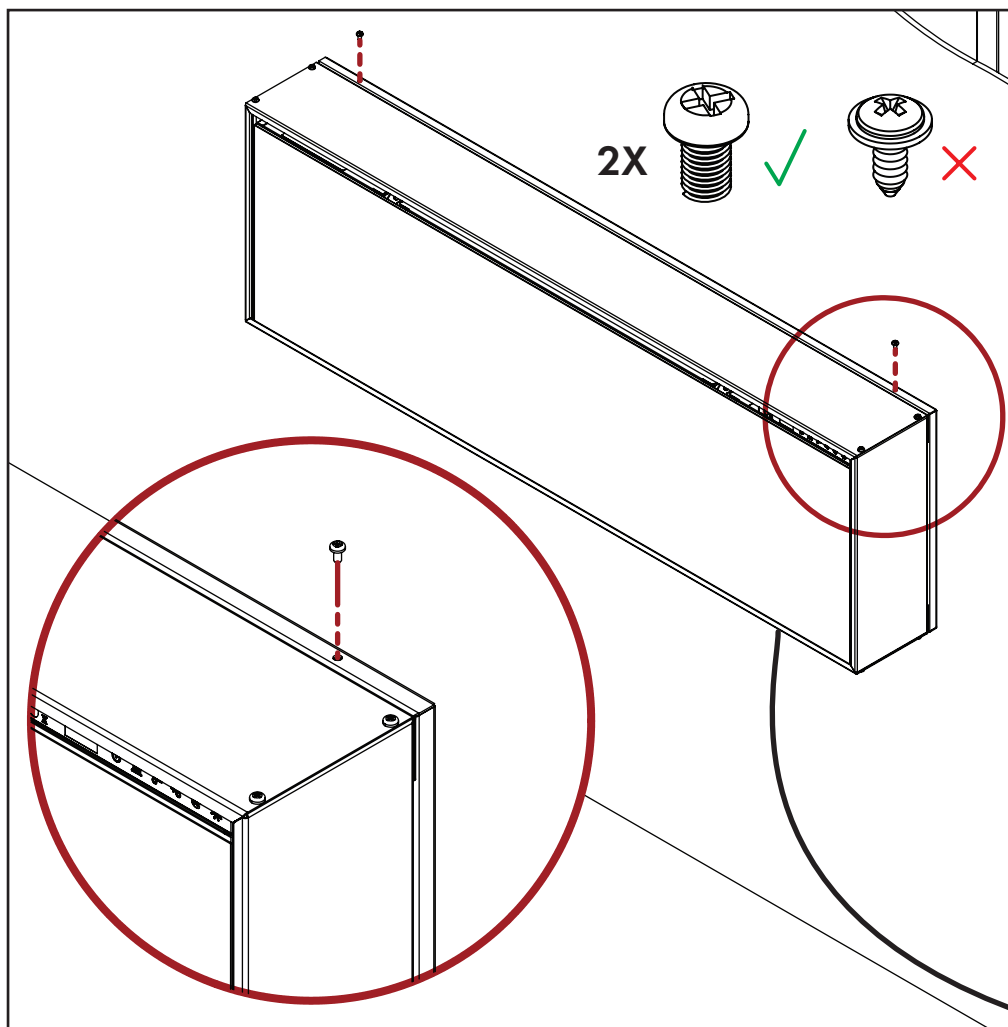

4.7. STEP 7

Ignite XLF50 Installation Kit has now been assembled and wall mounted. Please refer to the Ignite XLF50 instruction manual for further installation and operating instructions.

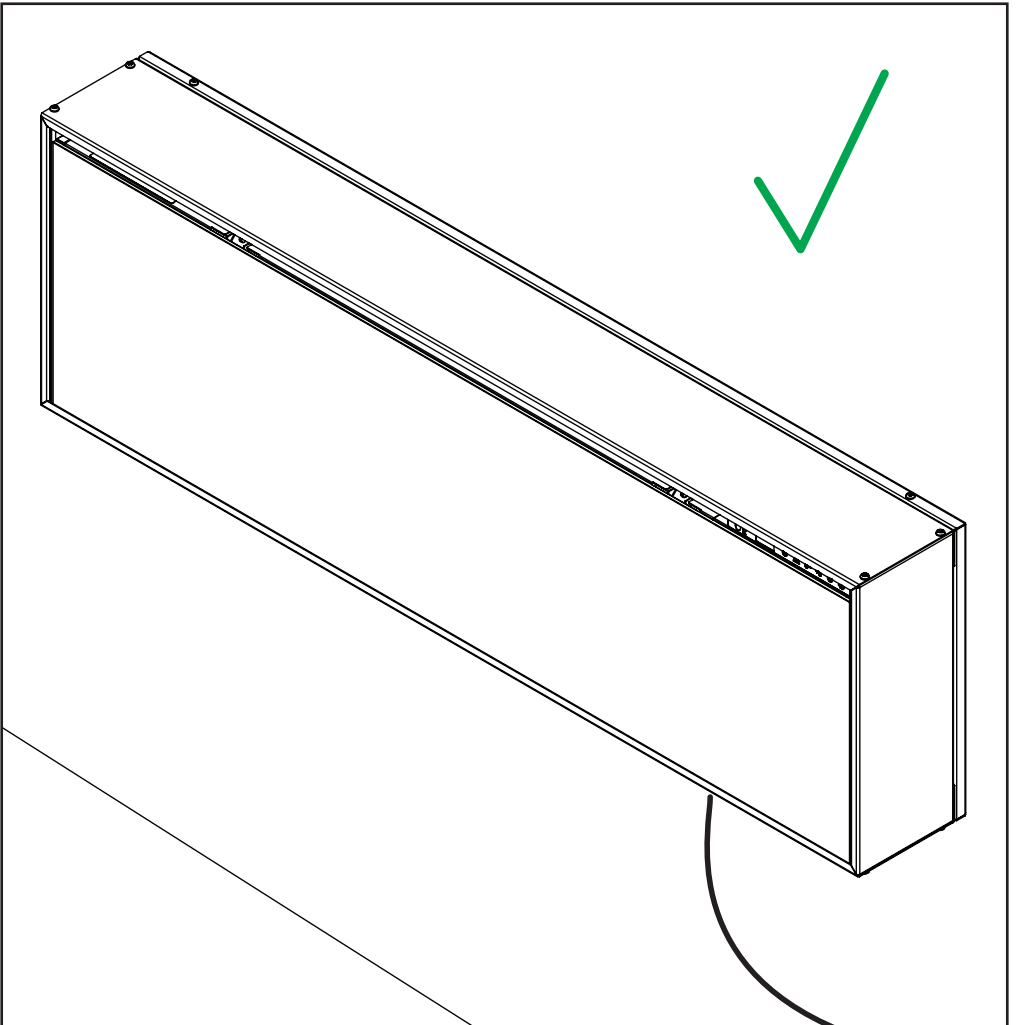

5. DIMENSIONS

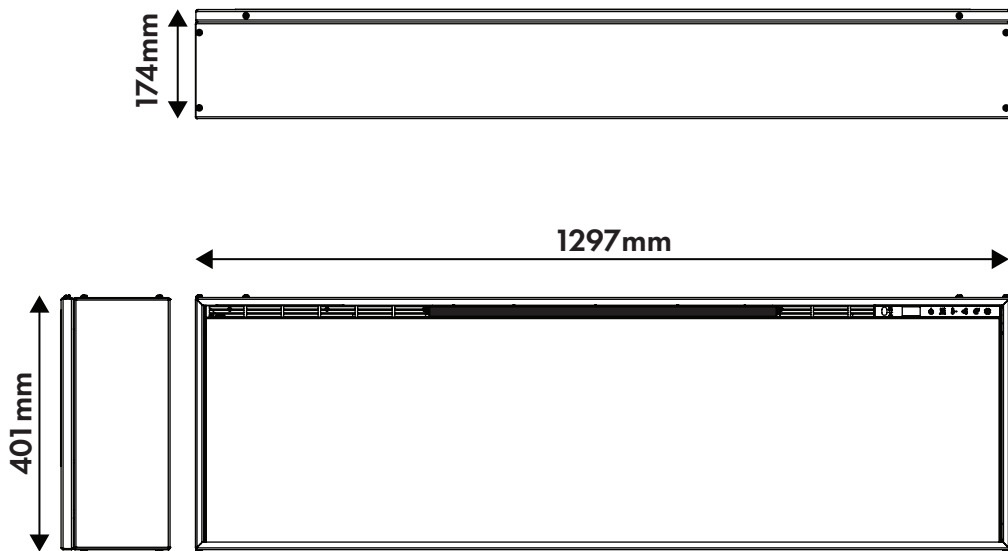

6. WARRANTY

The benefits provided to you under the following warranty are in addition to any other rights and remedies available to you under the law.

1. Warranty

If during the first 2 years from the date of purchase (Warranty Period), there is a defect in the Installation Kit (Product), due to improper workmanship or material, Glen Dimplex will replace or repair the Product without charge. Any replacement Product is warranted only for the time remaining on the original Warranty Period or the Parts Warranty Period as relevant.

2 . Registration

You must register to receive the benefit of this warranty by completing the warranty registration on our website within 30 days of purchase of your Product.

Australia:

<https://www.realflame.com.au/en-au/support/warranty>

New Zealand:

<https://www.realflame.co.nz/en-nz/support/warranty>

3 . Exclusions

Glen Dimplex is not obliged to replace or repair the Product under clause 1 if:

(a) it has been improperly stored, installed, assembled, used, operated or repaired, or damaged, abused,

tampered with, altered (without our written approval), or not maintained in strict accordance with our installation and operating instructions; or

(b) it has been installed in an outdoor setting.

4 . Limit of Liability

The warranty provided under this warranty is limited to replacement or repair of the Product only, at our option. To the extent permitted by law, Glen Dimplex excludes liability for consequential loss or any other loss or damage caused to property or persons arising from any cause whatsoever, and damage arising from normal wear and tear.

5 . Claiming under the Warranty

In order to claim under this warranty you must, within the Warranty Period or the Parts Warranty Period (as relevant), contact Glen Dimplex, providing the original proof of purchase and the details below:

Supplier Name_____

Date Of Purchase _____

Model / Serial Number_____

This warranty does not cover the cost of claiming under the warranty or transporting the Glen Dimplex Product to and from the supplier.

Our goods come with guarantees that cannot be excluded under the Australian Consumer Law and Consumer

Guarantees Act 1993 (New Zealand).
You are entitled to a replacement or refund for a major failure and for compensation for any other reasonably foreseeable loss or damage. You are also entitled to have the goods repaired or replaced if the goods fail to be of acceptable quality and the failure does not amount to a major failure.

6.1. AUSTRALIA WARRANTY CLAIMS

If you would like to speak to someone about your Product or claiming under this warranty, please contact the Service Warranty Desk on 1300 554 155.

Glen Dimplex Australia Pty Ltd

ACN 69 118 275 460

Head Office: 8 Lakeview Drive,
Scoresby 3179 Victoria, Australia

Phone: (03) 8706 2000

Fax: (03) 8706 2001

Email: flame@glendimplex.com.au

6.2. NZ WARRANTY CLAIMS

If you would like to speak to someone about your Product or claiming under this warranty, please contact the Service Warranty Desk on 0800 666 2824.

Glen Dimplex New Zealand Ltd

Head Office: 38 Harris Rd, East Tamaki
Auckland 2013, New Zealand

P.O Box 58473

Phone: (09) 274 8265

Fax: (09) 274 8472

Email: info@realflame.co.nz

7. NOTES

**Glen Dimplex Australia Pty Ltd**

8 Lakeview Drive,
Scoresby Victoria 3179
Australia

T: 1300 556 816 | F: 1800 058 900

Email: sales@glendimplex.com.au

www.glendimplex.com.au

Glen Dimplex New Zealand Pty Ltd

38 Harris Rd,
East Tamaki Auckland 2013
New Zealand

P.O. Box 58473

T: 09 274 8265 | F: 09 274 8472

Email: info@realflame.co.nz

www.glendimplex.co.nz